

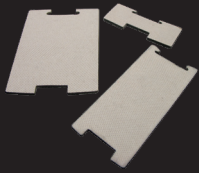

Magnoval

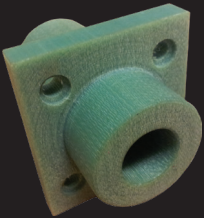

Specialised
Electrical
Insulation
Boards



Epoxy Glass
Laminates

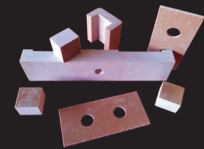

Rigid Electrical
Insulation
Materials



Epoxies and
Insulating
Compounds

AG Sydney
Head Office
02 9774 3333

syd@agaus.com.au

Magnoval is a specialised electrical material.

It is manufactured from a combination of iron powder, glass cloth and a modified epoxy resin.

The result is a tough, strong, rigid sheet material that has good magnetic conductivity and high resistivity.

Magnoval is most commonly used for making slot wedges for induction motors. When these are combined with a VPI insulation system, we suggest the use of Poromat 2248 as a bed material for fixing the slot wedges securely.

Magnoval is available in a selection of sizes from Associated Gaskets (listed below) and can also be supplied in finished slot wedges and all kinds of other components to suit your application requirements.

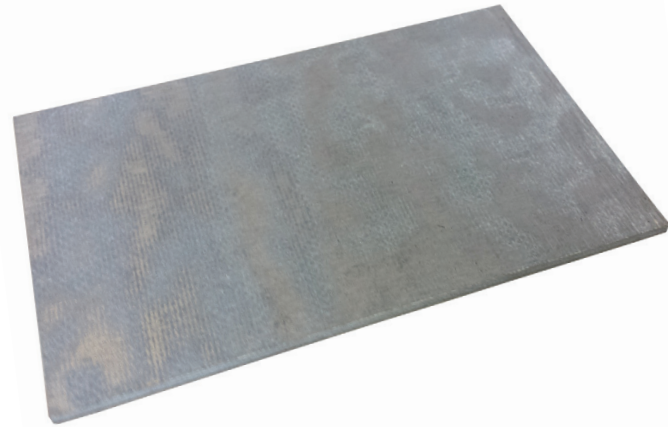

Key Specifications	
Temperature Index	155°C (IEC 216)
Density	3.5 g/cm ³
Flexural Strength	≥150 @ 23°C 120 @ 150°C
Modulus of Elasticity	~ 14.5 Pa @ 23°C
Iron Content	75% approx.
Glass Content	7 % approx.
Resin Content	18 % approx.
Resistivity	≥1 x 10 ⁶ Ohm x cm



Standrd Sizes	
Standard Thicknesses:	2.5mm, 3mm, 3.5mm, 4.5mm, 5mm, 6mm, 7mm
Maximum Sheet Size:	950mm x 1020mm

AG Queensland	AG Victoria	AG Western Australia	AG Newcastle	AG Wollongong
07 3257 1144	03 9768 3113	08 9258 5858	02 4967 7677	02 4272 4800

bris@agaus.com.au	melb@agaus.com.au	perth@agaus.com.au	new@agaus.com.au	woll@agaus.com.au
--	--	--	--	--

Visit agaus.com.au for more information and full contact details.